

OWNER'S STATEMENT

WE THE UNDERSIGNED, HAVING RECORD TITLE INTEREST IN THE HEREON SUBDIVIDED LANDS DO HEREBY CONSENT TO THE PREPARATION AND RECORDING OF THIS MAP.

DATED: 2-2-97

Delphian M. Cannon
DELPHIAN M. CANNON

COUNTY SURVEYOR'S STATEMENT

I HAVE EXAMINED THIS MAP AND FIND THAT IT IS SUBSTANTIALLY THE SAME AS IT APPEARED ON THE TENTATIVE MAP AND ANY APPROVED ALTERATIONS THEREOF. ALL PROVISIONS OF THE SUBDIVISION MAP ACT AND ANY LOCAL ORDINANCES APPLICABLE AT THE TIME OF APPROVAL OF THE TENTATIVE MAP HAVE BEEN COMPLIED WITH AND I AM SATISFIED THAT THE MAP IS TECHNICALLY CORRECT.

DATED: 9/9/97

R. Tom Hunter
R. TOM HUNTER R.C.E. 30515
PLUMAS COUNTY SURVEYOR
LICENSE EXPIRATION DATE 3-31-2000

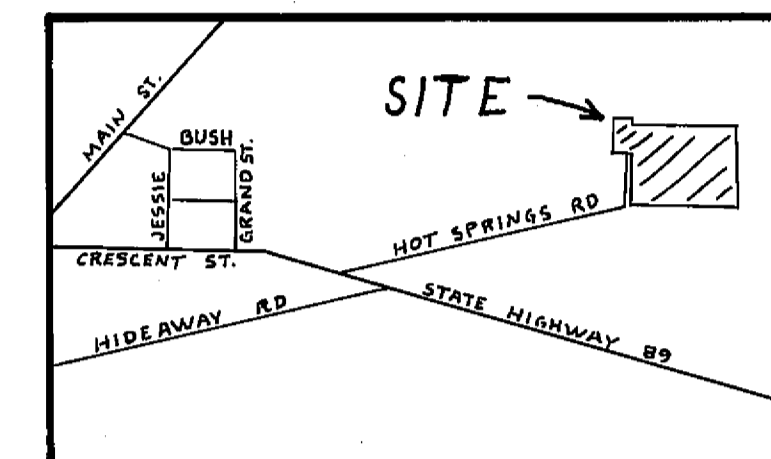
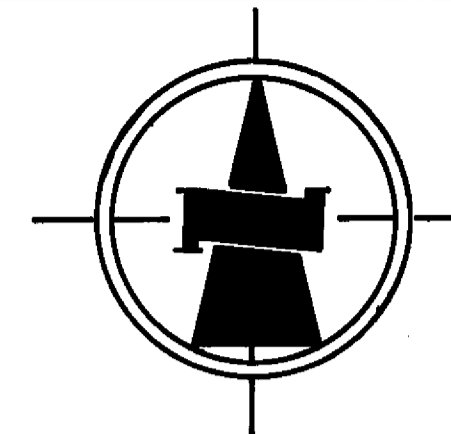

LOCATION MAP

NOTARY ACKNOWLEDGEMENT

STATE OF CALIFORNIA)
COUNTY OF PLUMAS)

ON THIS 2nd DAY OF February, 1997, BEFORE ME, THE UNDERSIGNED, A NOTARY PUBLIC IN AND FOR SAID STATE, PERSONALLY APPEARED DELPHIAN M. CANNON, PERSONALLY KNOWN TO ME, OR PROVED TO ME ON THE BASIS OF SATISFACTORY EVIDENCE, TO BE THE PERSON WHOSE NAME IS SUBSCRIBED TO THE WITHIN INSTRUMENT, AND ACKNOWLEDGED TO ME THAT SHE EXECUTED THE SAME IN HER AUTHORIZED CAPACITY, AND THAT BY HER SIGNATURE ON THE INSTRUMENT THE PERSON, OR THE ENTITY UPON BEHALF OF WHICH THE PERSON ACTED, EXECUTED THE INSTRUMENT.

WITNESS MY HAND AND OFFICIAL SEAL.

Len Franz
SIGNATURE

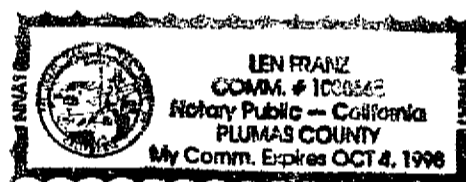

COUNTY TAX COLLECTOR'S CERTIFICATE

I, BARBARA J. COATES, TAX COLLECTOR OF THE COUNTY OF PLUMAS, STATE OF CALIFORNIA DO HEREBY CERTIFY THAT THERE ARE NO TAX LIENS AGAINST THE LOTS, AS SHOWN HEREON, FOR UNPAID STATE, COUNTY, MUNICIPAL, OR LOCAL TAXES OR SPECIAL ASSESSMENTS COLLECTED AS TAXES, EXCEPT TAXES OR ASSESSMENTS NOT YET PAYABLE. TAXES OR ASSESSMENTS WHICH ARE A LIEN BUT NOT YET PAYABLE, ARE ESTIMATED TO BE IN THE AMOUNT OF \$ 154.00

DATED: 8-29-97

Barbara J. Coates
Barbara J. Coates
BARBARA J. COATES
PLUMAS COUNTY TAX COLLECTOR

SURVEYOR'S STATEMENT

THIS MAP AND THE SURVEY PERFORMED THEREON IN SEPT. 1996 WERE MADE BY ME OR UNDER MY DIRECTION. THE SURVEY IS TRUE AND COMPLETE AS SHOWN. ALL OF THE MONUMENTS SHOWN HEREON ARE OF THE CHARACTER AND OCCUPY THE POSITIONS INDICATED AND ARE SUFFICIENT TO ENABLE THE SURVEY TO BE RETRACED.

DATED: 2/3/97

Ronald L. Graves
RONALD L. GRAVES P.L.S. 4085

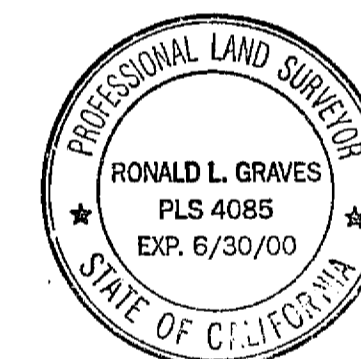

COUNTY RECORDER'S STATEMENT

FILED THIS 10th DAY OF September, 1997 AT 1:15 PM IN BOOK 8 OF MAPS, AT PAGE 62-63, AT THE REQUEST OF THE COUNTY SURVEYOR.

FEE \$ 10.00

JUDITH WELLS
COUNTY RECORDER

FILE NO 6202

BY Thomas R. Crawford
DEPUTY

COUNTY CLERK'S CERTIFICATE

I, JUDITH WELLS, CLERK OF THE COUNTY OF PLUMAS, STATE OF CALIFORNIA AND EX-OFFICIO CLERK OF THE BOARD OF SUPERVISORS OF SAID COUNTY, HEREBY CERTIFY THAT THE HEREIN EMBODIED MAP WAS APPROVED BY SAID BOARD OF SUPERVISORS CONVENED IN A REGULAR MEETING UPON THE 2nd DAY OF Sept 1997.

DATED: Sept 10, 1997

by: Judith Wells
JUDITH WELLS
COUNTY CLERK

DELPHI ANN SUBDIVISION

PARCEL 3 AS SHOWN ON THE HOLLINGSWORTH SUBDIVISION MAP, FILED IN BOOK 7 OF MAPS, AT PAGE 94; ALSO BEING A PORTION OF SECTION 2, TOWNSHIP 26 NORTH, RANGE 9 EAST, M.D.M., IN THE UNINCORPORATED AREA OF PLUMAS COUNTY, CALIFORNIA.
FOR DELPHIAN M. CANNON

Ron Graves
CIVIL ENGINEERS
LAND SURVEYORS
& associates
P.O. BOX 986 OROVILLE CAL. 95965
Ph. (916) 534-9587 96-088
APN 110-18-11 SH 1 of 2
PJM.97