

**ENGINEER'S STATEMENT**

THIS MAP AND SURVEY PERFORMED THEREFOR IN MARCH AND JUNE OF 1992 WERE MADE BY ME OR UNDER MY DIRECTION. THE SURVEY IS TRUE AND COMPLETE AS SHOWN. ALL THE MONUMENTS SHOWN HEREON ARE OF THE CHARACTER AND OCCUPY THE POSITIONS INDICATED AND ARE SUFFICIENT TO ENABLE THE SURVEY TO BE RE-TRACED.

*Larry A. Fites*  
LARRY A. FITES, R.C.E. 13225  
LICENSE EXP. DATE 3-31-93

**COUNTY SURVEYOR'S STATEMENT**

I HAVE EXAMINED THIS MAP AND FIND IT IS SUBSTANTIALLY THE SAME AS IT APPEARED ON THE TENTATIVE MAP AND ANY APPROVED ALTERATIONS THEREOF. ALL PROVISIONS OF THE SUBDIVISION MAP ACT AND ANY LOCAL ORDINANCES APPLICABLE AT THE TIME OF THE APPROVAL OF THE TENTATIVE MAP HAVE BEEN COMPLIED WITH AND I AM SATISFIED THAT THE MAP IS TECHNICALLY CORRECT.

DATED: 1-20-93  
*R. Tom Hunter*  
R. TOM HUNTER, R.C.E. 30515  
PLUMAS COUNTY SURVEYOR  
LICENSE EXP. DATE 3-31-96

**COUNTY RECORDER'S STATEMENT**

FILED THIS 4<sup>th</sup> DAY OF August 1993, AT 10:50 A.M. IN BOOK 7 OF MAPS, AT PAGE 87-89 AT THE REQUEST OF THE COUNTY SURVEYOR.

JUDITH WELLS  
COUNTY RECORDER  
BY: *JoAnn Van Melder*  
DEPUTY  
FEE: \$700  
FILE NO: 5726

**COUNTY TAX COLLECTOR'S CERTIFICATE**

I, BARBARA J. COATES, TAX COLLECTOR OF THE COUNTY OF PLUMAS, STATE OF CALIFORNIA, DO HEREBY CERTIFY THAT THERE ARE NO TAX LIENS AGAINST THE LOTS, AS SHOWN HEREON, FOR UNPAID STATE, COUNTY, MUNICIPAL, OR LOCAL TAXES OR SPECIAL ASSESSMENTS COLLECTED AS TAXES, EXCEPT TAXES OR ASSESSMENTS NOT YET PAYABLE. TAXES OR ASSESSMENTS WHICH ARE A LIEN BUT NOT YET PAYABLE, ARE ESTIMATED TO BE IN THE AMOUNT OF \$ NONE.

DATED: 7/26/93  
*Barbara J. Coates*  
BARBARA J. COATES  
PLUMAS COUNTY TAX COLLECTOR

**COUNTY CLERK'S CERTIFICATE**

I, JUDITH WELLS, CLERK OF THE COUNTY OF PLUMAS, STATE OF CALIFORNIA AND EX-OFFICIO CLERK OF THE BOARD OF SUPERVISORS OF SAID COUNTY, HEREBY CERTIFY THAT THE HEREIN EMBODIED MAP WAS APPROVED BY SAID BOARD OF SUPERVISORS CONVENED IN A REGULAR MEETING UPON THE 3<sup>RD</sup> DAY OF August, 1993, THE OFFER OF DEDICATION FOR THE ROADS AND PUBLIC UTILITY EASEMENTS, AS SHOWN ON THE MAP, WERE ACCEPTED FOR THE PUBLIC USES AS NOTED.

DATED: 8-4-93  
*Judith Wells*  
JUDITH WELLS  
COUNTY CLERK

**OWNER'S STATEMENT**

TIM T. BROWN, GARD M. ANDERSON, AND M. DONN MARSHALL, HAVING RECORD TITLE INTEREST IN THE HEREON SUBDIVIDED LANDS DO HEREBY CONSENT TO THE PREPARATION AND RECORDATION OF THIS MAP.

WE DO HEREBY OFFER FOR DEDICATION RIVER BEND WAY FOR PUBLIC ROAD AND DRAINAGE PURPOSES AND FOR PUBLIC UTILITY EASEMENT PURPOSES.

PUBLIC UTILITY EASEMENTS (P.U.E.), AS SHOWN ON THE MAP, ARE HEREBY OFFERED FOR DEDICATION FOR SUCH PURPOSES. PUBLIC UTILITY EASEMENTS INCLUDE THE SPECIFIC RIGHTS OF PACIFIC GAS & ELECTRIC COMPANY AND CP NATIONAL CORPORATION TO TRIM AND/OR REMOVE TREES AND BRUSH AS NECESSARY BY THE UTILITY COMPANY.

LOT A AND THE WATER SUPPLY EASEMENT WILL BE GRANTED TO HAMILTON BRANCH COMMUNITY SERVICE DISTRICT FOR MAINTENANCE AND OPERATION OF DISTRICT WATER SUPPLY AND WASTE DISPOSAL SYSTEMS AND FACILITIES.

*Tim T. Brown*  
TIM T. BROWN  
*Gard M. Anderson*  
GARD M. ANDERSON  
*M. Donn Marshall*  
M. DONN MARSHALL

STATE OF CALIFORNIA ) ss.  
COUNTY OF PLUMAS )

ON THIS 7<sup>th</sup> DAY OF October IN THE YEAR 1992, BEFORE ME, THE UNDERSIGNED, A NOTARY PUBLIC IN AND FOR SAID COUNTY AND STATE, PERSONALLY APPEARED TIMOTHY SURMINSKY, TIM T. BROWN, GARD M. ANDERSON, AND M. DONN MARSHALL, PERSONALLY KNOWN TO ME (OR PROVED TO ME ON THE BASIS OF SATISFACTORY EVIDENCE) TO BE THE PERSONS WHOSE NAMES ARE SUBSCRIBED TO THE WITHIN INSTRUMENT, AND ACKNOWLEDGED THAT THEY EXECUTED THE SAME.

*Clara A. Burwell*  
NOTARY PUBLIC IN AND FOR SAID COUNTY AND STATE  
10-5-93

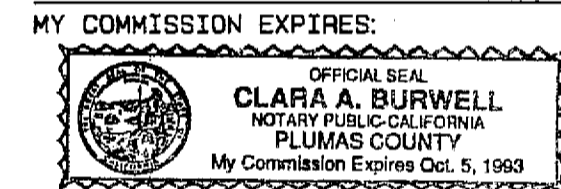

**TRUSTEE'S CERTIFICATE**

TICOR TITLE INSURANCE COMPANY, A CALIFORNIA CORPORATION AS TRUSTEE UNDER A DEED OF TRUST DATED OCTOBER 15, 1991, AND RECORDED IN BOOK 557 OF OFFICIAL RECORDS AT PAGE 381, DOES HEREBY CONSENT TO THE PREPARATION AND RECORDING OF THIS MAP AND CONSENT TO THE DEDICATION OF THE ROADS AND PUBLIC UTILITY EASEMENTS FOR THE PUBLIC USES AS NOTED.

DATED: January 14, 1993  
*Delphine Eisler*  
DELPHINE EISLER  
TITLE OFFICER

STATE OF CALIFORNIA  
COUNTY OF PLUMAS

ON JANUARY 11, 1993, BEFORE ME, SANDRA WING, NOTARY PUBLIC IN AND FOR THE STATE OF CALIFORNIA, PERSONALLY APPEARED DELPHINE EISLER PROVED TO ME ON THE BASIS OF SATISFACTORY EVIDENCE TO BE THE PERSON WHOSE NAME IS SUBSCRIBED TO THE WITHIN INSTRUMENT AND ACKNOWLEDGED TO ME THAT SHE EXECUTED THE SAME IN HER AUTHORIZED CAPACITY AND THAT BY HER SIGNATURE ON THE INSTRUMENT THE PERSON, OR THE ENTITY UPON BEHALF OF WHICH THE PERSON ACTED, EXECUTED THE INSTRUMENT. WITNESS MY HAND AND OFFICIAL SEAL.

*Sandra Wing*  
NOTARY PUBLIC IN AND FOR SAID COUNTY AND STATE  
10-23-95 SANDRA WING  
MY COMMISSION EXPIRES:

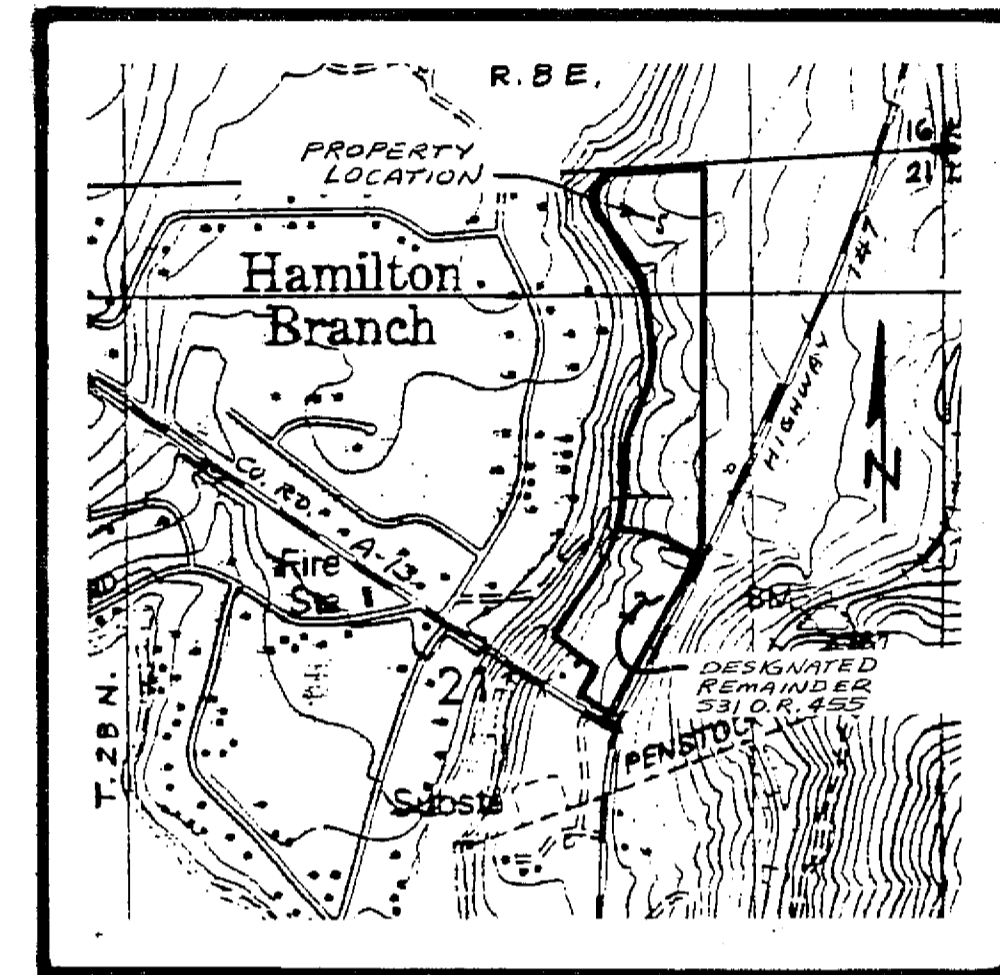
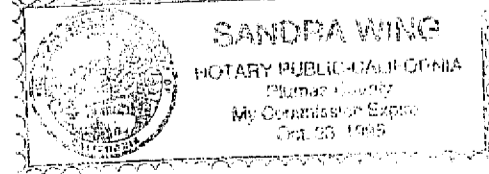

LOCATION MAP  
SCALE: 1" = 1000'

AREA TABULATION

LOTS 1 THROUGH 11	- 15.62
LOT A	- 0.61
PUBLIC ROADS	- 0.93
TOTAL	- 17.16

**CREEKSIDE SUBDIVISION**

BEING A PORTION OF THE EAST HALF OF SECTION 21, T. 28 N. R. 8 E., M.D.M., PLUMAS COUNTY, CALIFORNIA

BY:  
LARRY FITES ENGINEERING  
P.O. BOX 20308  
GRAEAGLE, CALIFORNIA 95103  
R.C.E. 13225