

Engineer's Statement

This map and the survey performed therefore on October 1, 1989 were made by me or under my direction. The survey is true and complete as shown. All of the monuments shown hereon are of the character and occupy the positions indicated and are sufficient to enable the survey to be retraced.

DATED: November 16, 1989

Fred R. Nagel
Fred R. Nagel
L.S. 3989
R.C.E. 26319

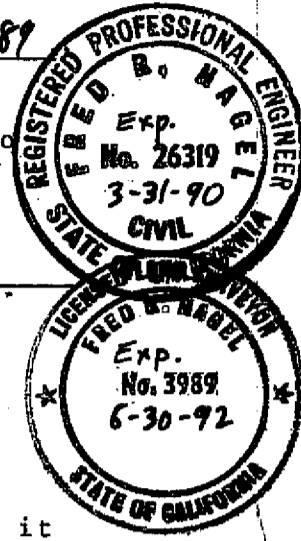

County Surveyor's Certificate

I have examined this map and find it is substantially the same as it appeared on the tentative map and any approved alterations thereof. All provisions of the Subdivision Map Act and any local ordinances applicable at the time of approval of the tentative map have been complied with and I am satisfied that the map is technically correct.

DATED: 12/5/89

Lawrence J. Brock
Lawrence J. Brock R.C.E. 13528
Plumas County Surveyor

County Recorder's Certificate

Filed this 5th day of December, 1989, at 1:50 P.m. in Book 6 of Maps, at page 104-106, at the request of the County Engineer.

Ila Diggs
County Recorder

File No. 8637

Fee \$9.00

By JoAnn Van Gelder
Deputy

County Tax Collector's Certificate

I, Barbara J. Coates, Tax Collector of the County of Plumas, State of California, do hereby certify that there are no tax liens against the Lots, as shown hereon, for unpaid state, county, municipal, or local taxes or special assessments collected as taxes, except taxes or assessments not yet payable. Taxes or assessments which are a lien but not yet payable, are estimated to be in the amount of \$ none.

DATED: 11-28-89

Barbara J. Coates
By: Bunny Schooley
Barbara J. Coates
Plumas County Tax Collector

County Clerk's Certificate

I, Ila Diggs, Clerk of the County of Plumas, State of California and Ex-Officio Clerk of the Board of Supervisors of said county, hereby certify that the herein embodied map was approved by the said Board of Supervisors convened in a regular meeting upon the 28th day of November, 1989. The offer of dedication for Wagon Road, Hill Top Road and the public utility easements as shown on the map were accepted for the uses noted.

The drainage and firebreak easements were not accepted at this time.

DATED: Nov. 29, 1989

Judith Wells
Ila Diggs
County Clerk

OWNER'S STATEMENT

I hereby certify that I am the owner of the land shown on this Subdivision Map and I consent to the preparation and recording of this map, and that I am the only person whose consent is required to pass clear title to said lands.

Wagon Road and Hill Top Road are hereby dedicated for public road, utility and drainage purposes. The public utility easements, drainage easements, and firebreak easement are hereby dedicated for public purposes as indicated.

Ramsey Construction, Inc.
Richard L. Ramsey
Richard L. Ramsey, President

CORPORATE NOTARY ACKNOWLEDGEMENT

State of CALIFORNIA
County of BUTTE SS.

On this 28th day of SEPTEMBER 1989, before me, the undersigned, a Notary public in and for said State, personally appeared RICHARD L. RAMSEY personally known to me (or proved to me on the basis of satisfactory evidence) to be the person who executed the within as PRESIDENT

or on behalf of the Corporation therein named and acknowledged to me that such corporation executed the within instrument pursuant to its by-laws or a resolution of its board of directors.

WITNESS my hand and official seal.

Signature Janean Dee Todd
Printed Name JANEAN DEE TODD

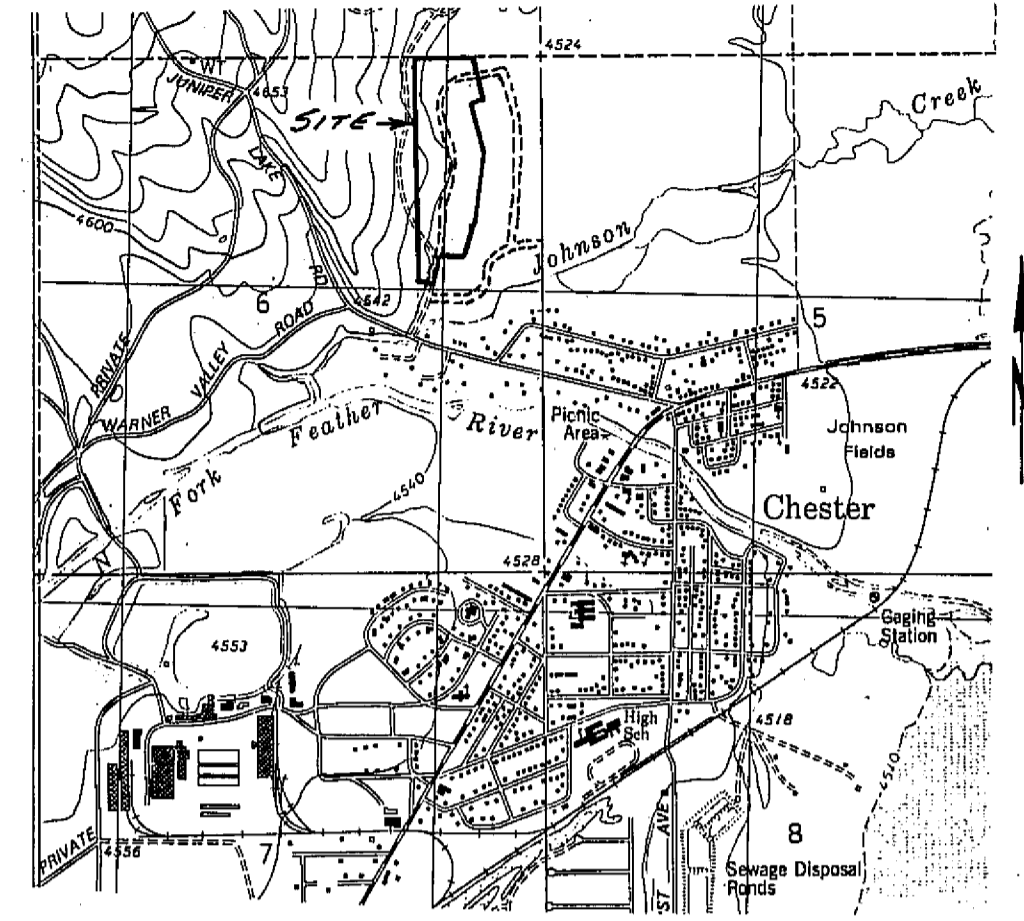
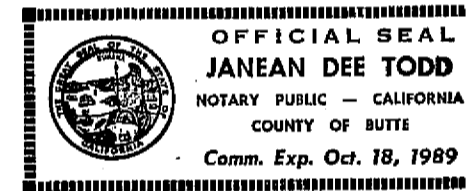

VICINITY MAP
1" = 2000'

Area Breakdown:
Lots = 31.62 Ac.
Roads = 4.03 Ac.
Total = 35.65 Ac.

MARTIN RANCH UNIT NO.2
IN A PORTION OF THE E.1/2, SECTION 6,
T. 28 N., R. 7 E., M.D.B. & M.
PLUMAS COUNTY, CALIFORNIA



NST ENGINEERING ASSOCIATES, INC.
45 SO. ROOP STREET
SUSANVILLE, CALIF. 96130
916-257-5173