

NOTE: THE RIGHT OF WAY FOR THE RAILROAD WAS RESET BASED ON THE CENTERLINE OF TRACK AT POINTS 75' FROM THE NORTH CORNER LOT AND NAIL IN TIE 1618.72' S 35° 40' 59" E

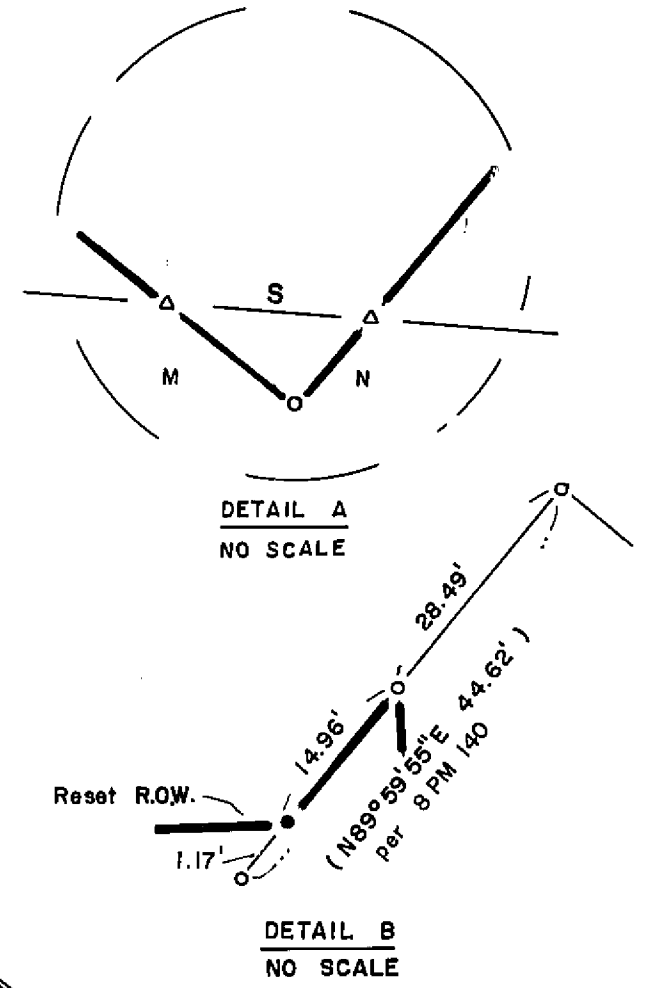

LEGEND

- o Fd. 1/2" rebar RCE 22836 per 8PM140, 6RSIII, 7RSIII
- ⊗ Fd. 3/4" I.P. RCE III73 per 1PM67 or as noted
- Set 1/2" rebar RCE 22836
- () Record and Measured per 7RSIII or as noted
- + + Record per 1PM67
- ⊗ Fd. 3/4" I.P. RCE III73 per 3RS19
- △ Calc. point
- () RI Record per 5 PM140, 3 RS19
- () R2 Record per 211 OR 401

Public Road Easement

g	N 49° 46' 51" E	85.00'	(N 49° 09' 21" E 95') * Old property line 10' South of new property line
h	N 40° 00' 28" W	44.91'	
s	S 49° 46' 51" W	87.95'	(S 49° 09' 21" W 95')
t	S 43° 45' 57" E	45.00'	(S 43° 08' 27" E 45')

Waterline Easement

a	122.25'	S 42° E
b	206.56'	N 77° E
c	179.98'	N 50° E
d	100.00'	N 77° E
e	180.00'	N 50° E
f	50.00'	S 42° E

Railroad Easement

I	N 0° 18' 11" E	102.60'
J	N 35° 40' 59" W	119.73'
K	S 50° W	126.64'
L	N 35° 40' 59" W	164.40'
M	N 0° 17' 48" E	0.66'
N	N 89° 59' 45" E	0.48'
O	N 35° 40' 59" W	196.35'
P	S 50° W	67.44'
Q	N 35° 40' 59" W	87.56'
R	N 0° 17' 36" E	114.48'
S	N 35° 40' 59" W	0.81'

GENERAL NOTES

- This map is a Division of a Portion of Lands surveyed in 7RS III.
- Basis of Bearings is the North Line of Chandler Road per 8PM 140.
- A supplemental information sheet is on file with the County Recorder in Book 469 of Official Records at Page 572.
- Subdivision Summary

Lots, net	17.28 ac.
Roads	0.15 ac.
Total	17.43 ac.

CHANDLER CREEK ESTATES, A Planned Development

A Subdivision of five lots within the SE 1/4 of Section 8, T24N, R10E, MDBM Plumas County, California

Owner: Marjorie J. Reid
dba Reid Land & Cattle Co
Rt 1 Box 710N
Quincy, CA. 95971

Engineer: Cliff Brown Engineering & Survey
Rt 1 Box 480 B
Quincy, CA. 95971

Feb 1987

sheet 2 of 2