

SUBDIVISION MAP & PLANNED UNIT DEVELOPMENT

OF COUNTRYMAN ESTATES

IN SECTIONS 11 & 12, T23N, R7E, M.D.M. PLUMAS COUNTY, CA. FOR

NORTHWEST PACIFIC RESOURCES, INC.

AREA OF LOTS 100.40 ACRES — AREA OF ROADS 6.88 ACRES — AREA OF SUBDIVISION 107.28 ACRES

CERTIFICATE OF TRUSTEES

TITLE INSURANCE AND TRUST COMPANY, A CALIFORNIA CORPORATION, AS TRUSTEE, UNDER THAT CERTAIN DEED OF TRUST RECORDED APRIL 30, 1981 IN BOOK 348 OF OFFICIAL RECORDS, AT PAGE 547, AND OROVILLE TITLE COMPANY, A CORPORATION, AS TRUSTEE, UNDER THAT CERTAIN DEED OF TRUST RECORDED JUNE 30, 1981 IN BOOK 352 OF OFFICIAL RECORDS, AT PAGE 437, HEREBY CONSENT TO THE PREPARATION AND RECORDATION OF THIS SUBDIVISION MAP.

Signature of Assistant Vice-President of Title Insurance & Trust Co., a Calif. Corp.

Signature of Assistant Secretary of Oroville Title Company, a Corp.

SURVEYOR'S CERTIFICATE

THIS MAP AND THE SURVEY PERFORMED THEREFORE IN JUNE 1981 WERE MADE BY ME OR UNDER MY DIRECTION. THE SURVEY IS TRUE & COMPLETE AS SHOWN. ALL MONUMENTS SHOWING POSITION AND CHARACTER AND OCCUPY THE POSITIONS INDICATED ARE SUFFICIENT TO ENABLE THE SURVEY TO BE RETRACED.

Signature of Richard Barnhart, Surveyor

STATE OF CALIFORNIA COUNTY OF Butte

ON 2-25-82 BEFORE ME, THE UNDERSIGNED, A NOTARY PUBLIC IN AND FOR SAID STATE, PERSONALLY APPEARED Spencer Robinson, KNOWN TO ME TO BE THE PERSON WHOSE NAME IS SUBSCRIBED TO THE WITHIN INSTRUMENT AND ACKNOWLEDGED THAT HE EXECUTED THE SAME.

Signature of Carol L. Bird, Notary Public

Signature of Carol L. Bird, Notary Public

COUNTY TAX COLLECTOR'S CERTIFICATE

I, BARBARA J. COKOR, COUNTY TAX COLLECTOR OF THE COUNTY OF PLUMAS STATE OF CALIFORNIA, DO HEREBY CERTIFY THAT THERE ARE NOT ANY TAX LIENS AGAINST THE LOTS, AS SHOWN HEREON, FOR UNPAID COUNTY, MUNICIPAL OR LOCAL TAXES OR SPECIAL ASSESSMENTS COLLECTED AS TAXES, EXCEPT TAXES OR ASSESSMENTS NOT YET PAYABLE. TAXES OR ASSESSMENTS WHICH ARE A LIEN BUT NOT YET PAYABLE, ARE ESTIMATED TO BE IN THE AMOUNT OF \$5,962.00

DATED 8/9/83

Signature of Barbara J. Cokor, Plumas County Tax Collector

OWNER'S CERTIFICATE

WE HEREBY CERTIFY THAT WE ARE OWNERS OF THE LAND SHOWN ON THIS SUBDIVISION MAP AND CONSENT TO PREPARATION AND RECORDING OF THIS MAP AND THAT WE ARE THE ONLY PERSONS WHOSE CONSENT IS REQUIRED TO PASS CLEAR TITLE TO SAID LANDS. THE EASEMENTS SHOWN ON THIS MAP TO BE CREATED BY RECORDATION THEREOF ARE CREATED WITH OUR CONSENT AND ARE HEREBY DEDICATED OR DECLARED TO BE FOR PUBLIC USE AS INDICATED. EASEMENTS FOR PUBLIC UTILITIES, ROADS, AND DRAINAGE FACILITIES ARE HEREBY DEDICATED FOR PUBLIC USE.

Signature of Theodore C. Cavello, President of Northwest Pacific Resources, Inc. DATE 8/23/82

STATE OF CALIFORNIA COUNTY OF Butte

ON 8-23-82 BEFORE ME, THE UNDERSIGNED, A NOTARY PUBLIC IN AND FOR SAID STATE, PERSONALLY APPEARED Theodore C. Cavello, KNOWN TO ME TO BE THE PRESIDENT AND SECRETARY OF THE CORPORATION THAT EXECUTED THE WITHIN INSTRUMENT, KNOWN TO ME TO BE THE PERSONS WHO EXECUTED THE WITHIN INSTRUMENT ON BEHALF OF THE CORPORATION THEREIN NAMED, AND ACKNOWLEDGED TO ME THAT SUCH CORPORATION EXECUTED THE WITHIN INSTRUMENT PURSUANT TO BY-LAWS OR A RESOLUTION OF ITS BOARD OF DIRECTORS.

Signature of Elva L. Boatwright, Notary Public

Signature of Elva L. Boatwright, Notary Public. EXPIRATION Oct. 26, 1984

COUNTY SURVEYOR'S CERTIFICATE

I HAVE EXAMINED THIS MAP AND FIND IT IS SUBSTANTIALLY THE SAME AS IT APPEARED ON THE TENTATIVE MAP AND ANY APPROVED ALTERATIONS THEREOF. ALL PROVISIONS OF THE SUBDIVISION MAP ACT AND ANY LOCAL ORDINANCES APPLICABLE AT THE TIME OF APPROVAL OF THE TENTATIVE MAP HAVE BEEN COMPLIED WITH, AND I AM SATISFIED THAT THE MAP IS TECHNICALLY CORRECT.

DATED August 9, 1983

Signature of Lawrence D. Brock, Plumas County Surveyor

COUNTY CLERKS CERTIFICATE

I, ILA DIGGS, CLERK OF THE COUNTY OF PLUMAS, STATE OF CALIFORNIA, AND EX-OFFICIO CLERK OF THE BOARD OF SUPERVISORS OF SAID COUNTY, HEREBY CERTIFY THAT THE HEREIN EMBODIED MAP WAS APPROVED BY THE SAID BOARD OF SUPERVISORS CONVENED IN A REGULAR MEETING UPON THE 9th DAY OF August, 1983, AND THE EASEMENTS AND ROADS SHOWN ON THE MAP WERE ACCEPTED FOR THE USES NOTED.

DATE 8/9/83

Signature of Ila Diggs, Deputy County Clerk

COUNTY RECORDER'S CERTIFICATE

FILED THIS 9th DAY OF August, 1983 AT 2:48 P.M. IN BOOK 5 OF MAPS, AT PAGE 106, AT THE REQUEST OF THE COUNTY ENGINEER.

FEE \$11.00

FILE NO. 237

ILA DIGGS COUNTY RECORDER

Signature of Beth Cammack, Deputy

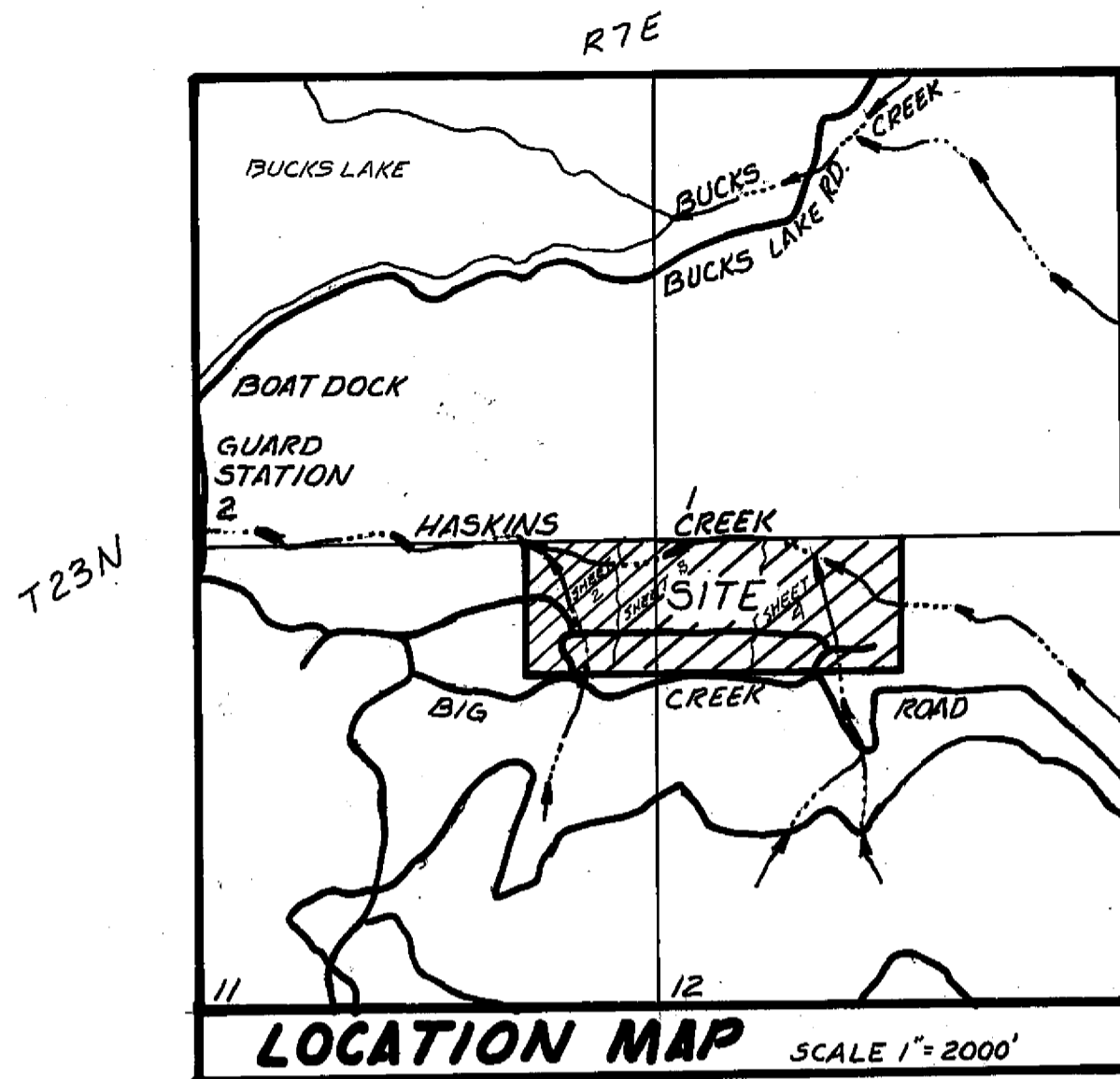

CERTIFICATE OF BENEFICIARY

ROBINSON CONSTRUCTION COMPANY, INC., A CALIFORNIA CORPORATION, AS BENEFICIARY UNDER DEED OF TRUST RECORDED DECEMBER 29, 1981 IN BOOK 363 OF OFFICIAL RECORDS, AT PAGE 77, HEREBY CONSENTS TO THE PREPARATION AND RECORDATION OF THIS SUBDIVISION MAP.

Signature of Spencer Robinson

STATE OF CALIFORNIA COUNTY OF Plumas

ON March 1, 1982 BEFORE ME, THE UNDERSIGNED, A NOTARY PUBLIC IN AND FOR SAID STATE, PERSONALLY APPEARED LAURENCE O. VETTER CARL S. PAULSER KNOWN TO ME TO BE THE ASSISTANT VICE PRESIDENT OF THE CORPORATION THAT EXECUTED THE WITHIN INSTRUMENT, KNOWN TO ME TO BE THE PERSON WHO EXECUTED THE WITHIN INSTRUMENT ON BEHALF OF THE CORPORATION THEREIN NAMED, AND ACKNOWLEDGED TO ME THAT SUCH CORPORATION EXECUTED THE WITHIN INSTRUMENT PURSUANT TO ITS BY-LAWS OR A RESOLUTION OF ITS BOARD OF DIRECTORS.

Signature of Delphine E. Eisler, Notary Public

Signature of Delphine E. Eisler, Notary Public. EXPIRATION 11-1-85

STATE OF CALIFORNIA COUNTY OF Butte

ON Feb. 25, 1983 BEFORE ME, THE UNDERSIGNED, A NOTARY PUBLIC IN AND FOR SAID STATE, PERSONALLY APPEARED Jack Steele, KNOWN TO ME TO BE THE ASSISTANT SECRETARY OF THE CORPORATION THAT EXECUTED THE WITHIN INSTRUMENT, KNOWN TO ME TO BE THE PERSON WHO EXECUTED THE WITHIN INSTRUMENT ON BEHALF OF THE CORPORATION THEREIN NAMED, AND ACKNOWLEDGED TO ME THAT SUCH CORPORATION EXECUTED THE WITHIN INSTRUMENT PURSUANT TO ITS BY-LAWS OR A RESOLUTION OF ITS BOARD OF DIRECTORS.

Signature of Elva L. Boatwright, Notary Public

Signature of Elva L. Boatwright, Notary Public. EXPIRATION Oct. 26, 1984

Advertisement for Ron Graves & Associates, Surveying, Parcel Maps, Public Reports. P.O. BOX 1576, Oroville, Cal. 95965. Ph. (916) 534-1911. SHEET 1 OF 4 SHEETS