

OWNER'S CERTIFICATE

I HEREBY CERTIFY THAT I AM THE OWNER OF THE LAND SHOWN ON THIS SUBDIVISION MAP AND CONSENT TO THE PREPARATION AND RECORDING OF THIS MAP AND THAT I AM THE ONLY PERSON WHOSE CONSENT IS REQUIRED TO PASS CLEAR TITLE OF SAID LAND, THE EASEMENTS SHOWN ON THIS MAP TO BE CREATED BY RECORDATION THEREOF ARE CREATED WITH MY CONSENT AND ARE HEREBY DEDICATED OR DECLARED TO BE FOR PRIVATE USE AS INDICATED. EASEMENTS FOR PUBLIC UTILITIES ARE HEREBY DEDICATED FOR PUBLIC USES.

Willard Harvey Wattenburg
WILLARD HARVEY WATTENBURG

NOTARY

STATE OF CALIFORNIA SS
COUNTY OF PLUMAS

ON January 4, 1984, BEFORE ME, THE UNDERSIGNED, A NOTARY PUBLIC IN AND FOR SAID STATE, PERSONALLY APPEARED WILLARD HARVEY WATTENBURG, PERSONALLY KNOWN TO ME OR PROVED TO ME ON THE BASIS OF SATISFACTORY EVIDENCE TO BE THE PERSON WHOSE NAME IS SUBSCRIBED TO THE WITHIN INSTRUMENT, AND ACKNOWLEDGED TO ME THAT HE EXECUTED IT.

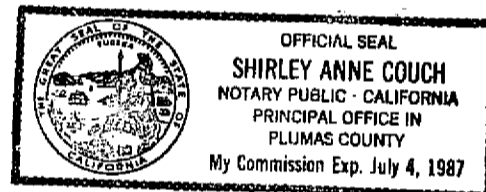

Shirley Anne Couch
NOTARY PUBLIC

COUNTY CLERK'S CERTIFICATE

I, ILA DIGGS, CLERK OF THE COUNTY OF PLUMAS, STATE OF CALIFORNIA AND EX OFFICIO CLERK OF THE BOARD OF SUPERVISORS OF SAID COUNTY, HEREBY CERTIFY THAT THE HEREIN EMBODIED MAP WAS APPROVED BY THE SAID BOARD OF SUPERVISORS CONVENED IN REGULAR MEETING UPON THE 19th DAY OF February 1985. AND THE OFFER OF DEDICATION FOR EASEMENTS AS SHOWN ON THE MAP WERE ACCEPTED FOR THE USES NOTED.

DATED: February 21, 1985

Ila Diggs
ILA DIGGS
PLUMAS COUNTY CLERK

ENGINEER'S CERTIFICATE

THIS MAP AND THE SURVEY PERFORMED THEREFORE IN OCTOBER 1983, WERE MADE BY ME OR UNDER MY DIRECTION. THE SURVEY IS TRUE AND COMPLETE AS SHOWN. ALL MONUMENTS SHOWN HEREON ARE OF THE CHARACTER AND OCCUPY THE POSITIONS INDICATED AND ARE SUFFICIENT TO ENABLE THE SURVEY TO BE RETRACED.



Clifford R. Brown
CLIFFORD R. BROWN RCE 22836

COUNTY SURVEYOR'S CERTIFICATE

I HAVE EXAMINED THIS MAP AND FIND IT IS SUBSTANTIALLY THE SAME AS IT APPEARED ON THE TENTATIVE MAP AND ANY APPROVED ALTERATIONS THEREOF, ALL PROVISIONS OF THE SUBDIVISION MAP ACT AND LOCAL ORDINANCES APPLICABLE AT THE TIME OF APPROVAL OF THE TENTATIVE MAP HAVE BEEN COMPLIED WITH, AND I AM SATISFIED THAT THE MAP IS TECHNICALLY CORRECT.

DATED: 2-20-85

Lawrence J. Brock
LAWRENCE J. BROCK RCE 13528
PLUMAS COUNTY ENGINEER

COUNTY TAX COLLECTOR'S CERTIFICATE

I BARBARA J. COKOR, TAX COLLECTOR OF THE COUNTY OF PLUMAS, STATE OF CALIFORNIA, DO HEREBY CERTIFY THAT THERE ARE NO TAX LIENS AGAINST THE LOTS AS SHOWN HEREON FOR UNPAID COUNTY, MUNICIPAL OR LOCAL TAXES OR SPECIAL ASSESSMENTS COLLECTED AS TAXES, EXCEPT TAXES OR ASSESSMENTS NOT YET PAYABLE. TAXES OR ASSESSMENTS WHICH ARE A LIEN BUT NOT YET PAYABLE ARE ESTIMATED TO BE IN THE AMOUNT OF NONE.

DATED: 2/21/85

Barbara J. Cokor
BARBARA J. COKOR
PLUMAS COUNTY TAX COLLECTOR

COUNTY RECORDER'S CERTIFICATE

FILED THIS 25th DAY OF February 1985, AT 2:30 P.M., IN BOOK 5 OF MAPS AT PAGE 146:147 AT THE REQUEST OF THE COUNTY ENGINEER.

FEE: \$ 700

ILA DIGGS, COUNTY RECORDER

FILE NO. 5774

by *Patricia Lacey*
DEPUTY

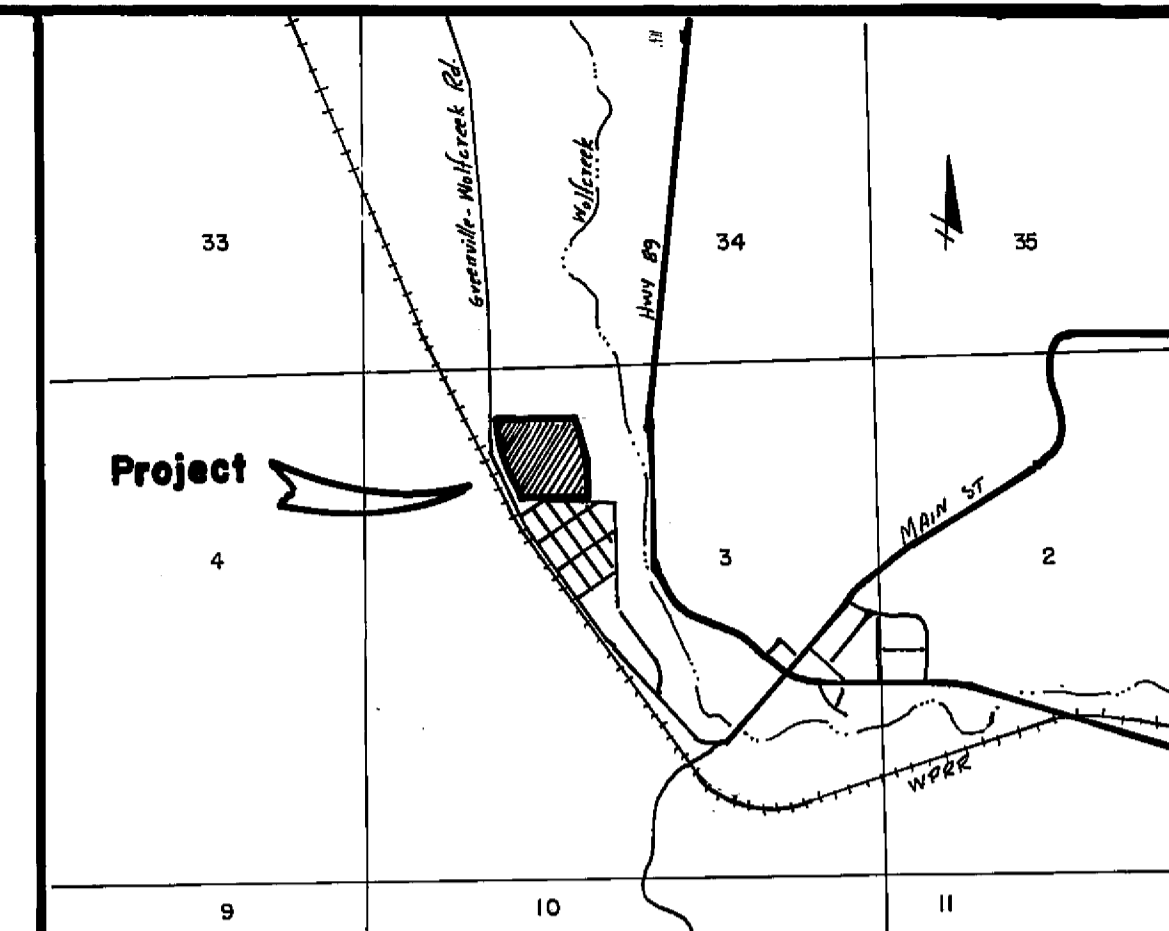

LOCATION MAP T26N R9E
1" = 2000'

MILL SITE SUBDIVISION NO. 1

BEING A PORTION OF SECTION 3 T26N R9E MDB & M
PLUMAS Co. CALIFORNIA

DEVELOPER WILLARD WATTENBURG

ENGINEER CLIFFORD R. BROWN Engineering & Surveying
Rt. 1 Box 480 B Quincy, California

OCTOBER 1983

bb

Sheet 1 of 2