

# DIXIE VALLEY PROPERTIES UNIT 1

BEING A PORTION OF  
SECTIONS 6, 7, 17, 18, 20 AND 21  
TOWNSHIP 24 NORTH, RANGE 15 EAST, M.D.M.

PLUMAS COUNTY, CALIFORNIA  
SCALE: 1" = 200'  
OCTOBER, 1971  
THE MURRAY - MCCORMICK ENVIRONMENTAL GROUP  
RENO, NEVADA  
SHEET 7 OF 9 SHEETS

U. S. A.

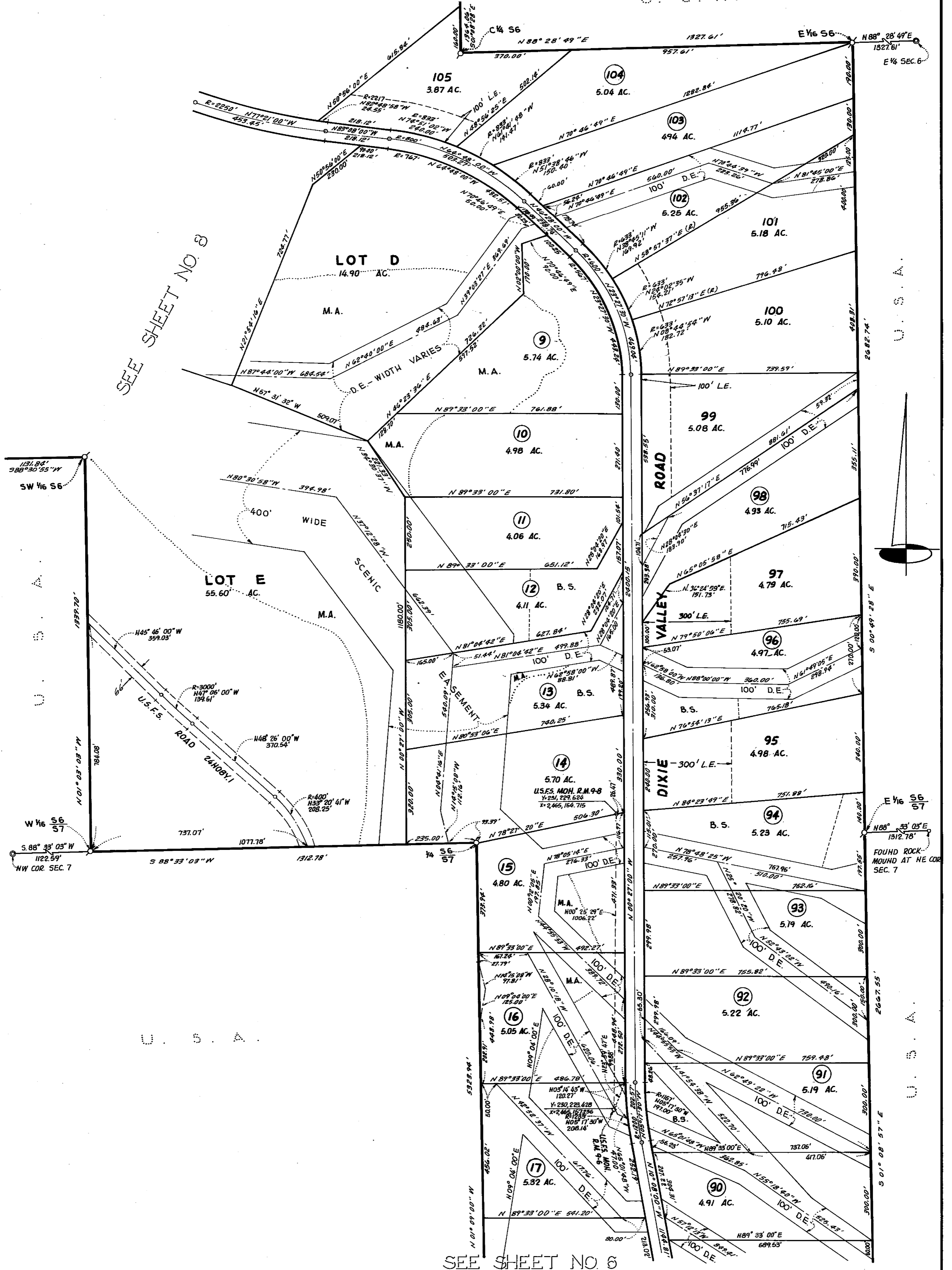

SEE SHEET NO. 3

SEE SHEET NO. 6

4 M 11