

NOTE: BASIS OF BEARINGS IS THE NORTHEAST LINE OF BELL LANE GIVEN AS  $S 36^{\circ} 20' 16'' E$  AS SHOWN ON INDIAN SPRINGS ESTATES SUBDIVISION UNIT NO. ONE.

CURVE DATA:  
 "A"  $\Delta = 91^{\circ} 14' 00''$ ,  $R = 20.00'$ ,  $L = 31.85'$   
 "B"  $\Delta = 14^{\circ} 50' 09''$ ,  $R = 195.00'$ ,  $L = 50.49'$   
 "C"  $\Delta = 14^{\circ} 50' 09''$ ,  $R = 255.00'$ ,  $L = 66.03'$

LEGEND:  
 ○ SET  $\frac{3}{4}$ " IRON PIPE  
 ● FOUND  $\frac{3}{4}$ " IRON PIPE  
 [Hatched Area] RESTRICTED BUILDING AND SANITARY LEACH AREA

TOTAL ACREAGE: 36.63 ACRES

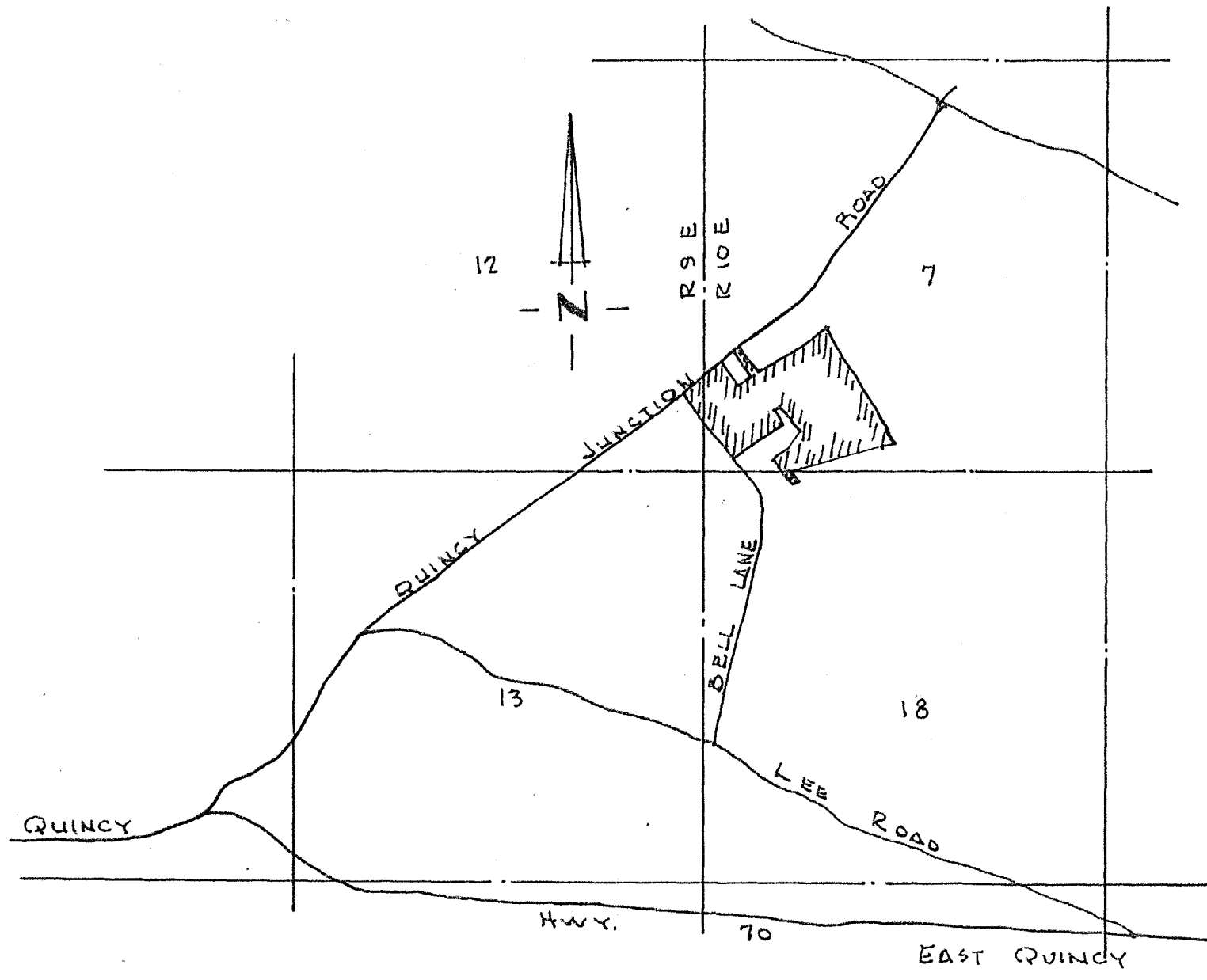

LOCATION MAP  
 1" = 2000'

RESUBDIVISION OF A PORTION OF INDIAN SPRINGS ESTATES SUBDIVISION UNIT NO. ONE AND

A PORTION OF THE PARCEL MAP RECORDED IN BOOK 2 AT PAGE 33 & A PORTION OF SECTIONS 7 8 18, T24N, R10E & SECTION 12 T24N, R9E, MDB&M. IN PLUMAS COUNTY, CALIFORNIA

OWNER & SUBDIVIDER: ROBERT D. & MARGURITE A. MITCHELL  
 DARRELL R & PHYLLIS M. PAYNE  
 ENGINEER: DONALD C. MAJOR, QUINCY, CALIF.

SCALE: 1" = 200'

JULY 1969

SHEET 2 OF 2 SHEETS

3M94