

CURVE DATA

A.	Δ=90° R=20.00' L=31.42'	E.	Δ=46°27'07" R=200' L=162.15'
B.	Δ=72°17'41" R=20.00' L=25.23'	F.	Δ=81°56'30" R=115.16' L=164.70'
C.	Δ=80°14'14" R=100.00' L=140.04'	G.	Δ=1°02'57" R=130.96' L=240'
D.	Δ=90° R=100.00' L=157.08'	H.	Δ=46°25'16" R=160.96' L=130.41'
J.	Δ=89°11'37" R=20.00' L=31.13'	I.	Δ=90°48'23" R=20.00' L=31.70'
K.	Δ=25°50'30" R=150.00' L=67.65'		
L.	Δ=44°24'55" R=20.00' L=15.50'		
M.	Δ=97°32'44" (Not concentric) R=80.00' L=85.15'		

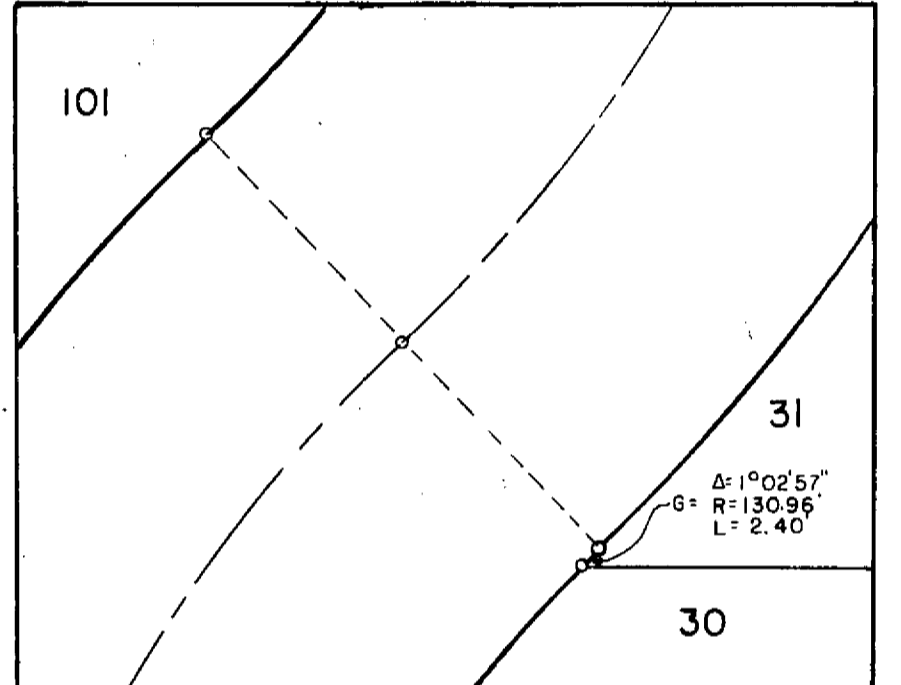

RESUBDIVISION OF IRON HORSE RANCHO SUBDIVISION

BEING A PORTION OF SECTIONS
3, 10 AND 11, T 22 N, R 13 E, M. D. B. & M.

OWNER AND SUBDIVIDER
IRON HORSE INVESTMENTS
a limited partnership

SCALE 1"=200' NOVEMBER, 1969

LEGEND

- 4x20' ANCHOR EASEMENT
- 3/4" IRON PIPE OR 1/2" BOLT, EXCEPT ON E OF ROADS
1" IRON PIPE
- 1/2" OF STREAM OR WATERCOURSE
- SETBACK LINE
- Total Acreage 243.86 ac.

NOTES

1. Roads shown hereon are private roads not subject to County improvement or maintenance. It will be required that such roads be improved to County standards at no cost to the County before such roads will be accepted into the County road system.
2. The following setbacks, in addition to those shown above, shall apply to the respective lots.
 - * 20' Building Setback - all lots

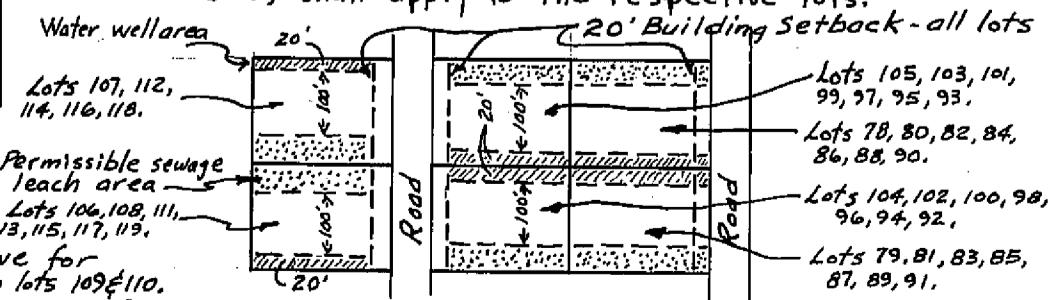

ENGINEERING OFFICE OF
WALTER B. GRIMES
AND ASSOCIATES
REGISTERED CIVIL ENGINEER NO. 7294
CHICO CALIFORNIA

LOCATION MAP
SCALE 1"=1 mile

* See map above for special condition on lots 109 & 110.