

# CORNER RECORD

Document Number 348  
County of Plumas, California

City of n/a

Brief Legal Description Cor. of secs. 1, 2, 35 and 36, Tps27 & 28N, R10E, MDM, CA  
(GCDB 600700 // Index A-21)

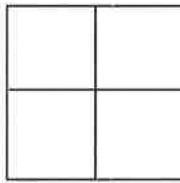

## CORNER TYPE

Government Corner ☒ Control ☐  
Meander ☐ Property ☐  
Rancho ☐ Other ☐

## COORDINATES(Optional)

N. n/a  
E. n/a  
Zone n/a NAD27 ☐ NAD83 ☐  
NAD83 Epoch n/a  
Elev. n/a  
Vert. Datum: NGVD29 ☐ NADV88 ☐  
Meas. Units: Metric ☐ Imperial ☒

Date of Survey 6/13/2006

**Note:** This is a cor. refurbishment. No survey tie to distant cors. performed.

Corner - Left as found ☐ Found and tagged ☐ Established ☐ Reestablished ☐ Rebuilt ☒

Identification and type of corner found: Evidence used to identify or procedure used to establish or reestablish the corner:

Original corner set by James Barnham, under GLO Contract dated July 25, 1878, with Plat approval date of February 23, 1881, and no approval date for the Contract or Field Notes available from the BLM.

This corner was remonumented by Loren J. Sargent, LS 2322, during survey recorded March 7, 1975, in Plumas County Record of Surveys Book 4, page 79 (4-RS-79)

This corner was remonumented by Albert M. Rauch, cadastral surveyor, under Group No. 660, approved May 16, 1977.

Recovered original bearing tree remains: A snag, 49 ins. diam., bears S. 45½° W., 9 lks. dist., with open blaze;

A cedar, 21 ins. diam., alive and healthy, bears N. 75° W., 45 lks. dist., with healed blaze.

Recovered Rauch bearing tree remains:

A fir stump, 24 ins. diam., bears N. 38° E., 27 lks. dist.

A cedar, 11 ins. diam., alive and healthy, bears S. 89° E., 63 lks. dist., with scribe mks. visible in partially healed blaze.

A description of the physical condition of the monument as found and as set or reset:

Found a standard BLM 3¼ ins. diam. brass cap on 2½ ins. diam. iron post, firmly set in good condition, 8 ins. above ground, in rock mound, 2½ ft. base to top, mkd. (see attached sketch), with ¾ in. diam. iron pipe tagged LS-2322 alongside.

New bearing trees;

A cedar, 11 ins. diam., bears N. 35° E., 24.7 ft. dist., mkd. T28N R10E S36 BT.

A fir, 9 ins. diam., bears S. 57½° W., 35.0 ft. dist., mkd. T27N R10E S2 BT

## SURVEYOR'S STATEMENT

This Corner Record was prepared by me or under my direction in conformance with

the Land Surveyors Act on April 23, 2007

Signed: Ron C. Walter

Ron C. Walter

L.S. No.: 6501



## COUNTY SURVEYORS STATEMENT

This Corner Record was received June 20th, 2007 and examined

and filed June 25th, 2007

Signed: Tom Hunter

P.L.S. or R.C.E. No.: PCE 30515

Title County Surveyor

County Surveyors Comment



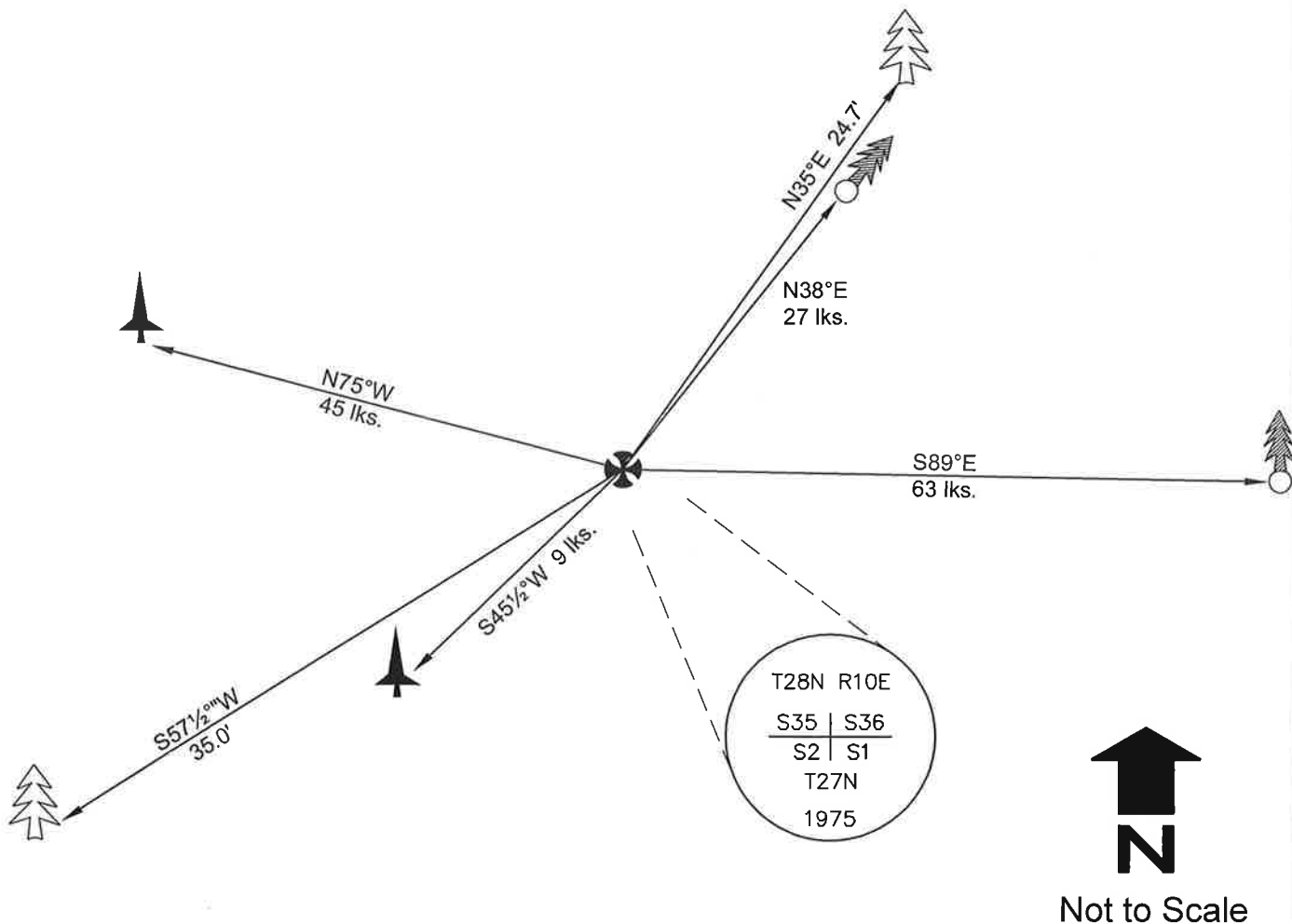

(GCDB 600700 // Index A-21)







**Cor. of secs. 1, 2, 35 and 36**  
**Tps27 & 28N, R10E, MDM, CA**  
**Wallowa Associates - Ron Walter, LS**  
**April 23, 2006**

## **NOTES**

1. The True Meridian is the Basis of Bearing.

## **LEGEND**

-  Recovered original cadastral corner.
-  Recovered original bearing tree or remains.
-  Recovered bearing tree of record.
-  New bearing tree - established this survey.